

Components

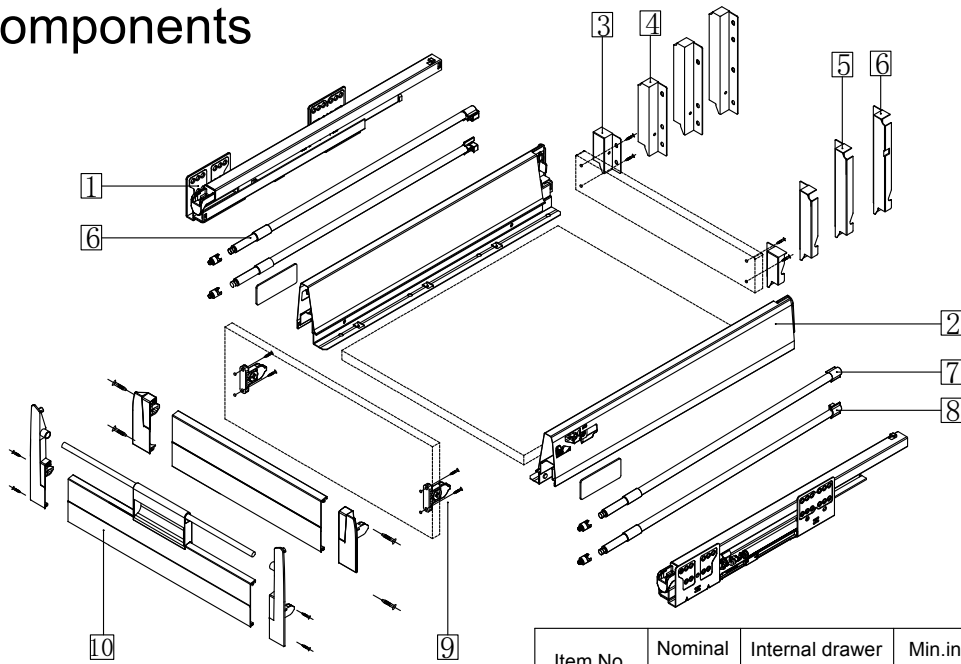

Item No.	Nominal length	Internal drawer length	Min.installation length of drawer
	270mm	244mm	280mm
	300mm	274mm	310mm
	350mm	324mm	360mm
	400mm	374mm	410mm
	450mm	424mm	460mm
	500mm	474mm	510mm
	550mm	524mm	560mm

- | | |
|-------------------------------|-------------------------------|
| 1.Cabinet profiles: (L/R) | 6.204 Rear connecting bracket |
| 2.Drawer profiles: (L/R) | 7.Gallery tube |
| 3.86 Rear connecting bracket | 8.Middle tube |
| 4.140 Rear connecting bracket | 9.Front fixing brackets |
| 5.164 Rear connecting bracket | 10.Front panel |

B140 Installation dimensions

Assembling dimensions of cabinet

Front fixing bracket

Drilling hole size on drawer front

Drawer back

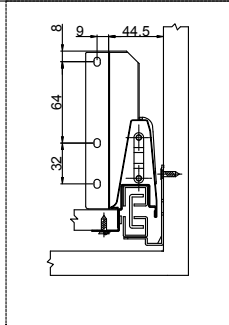
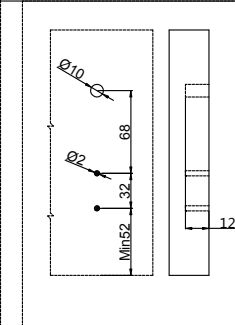
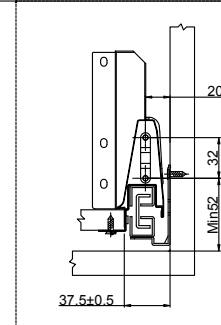
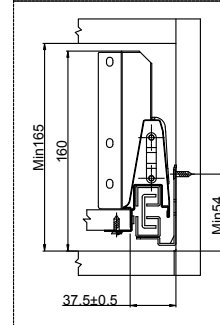

B164 Installation dimensions

Assembling dimensions of cabinet

Front fixing bracket

Drilling hole size on drawer front

Drawer back

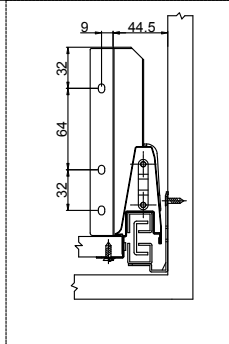
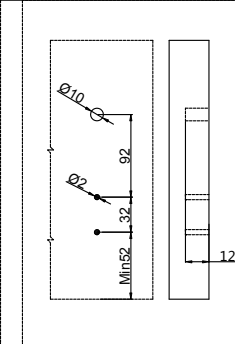
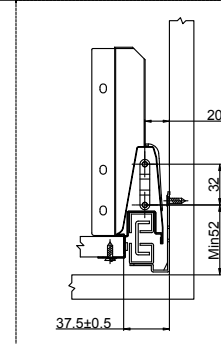
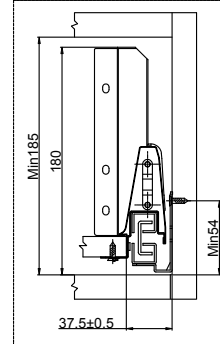

B204 Installation dimensions

Assembling dimensions of cabinet

Front fixing bracket

Drilling hole size on drawer front

Drawer back

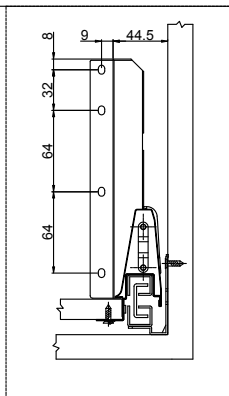
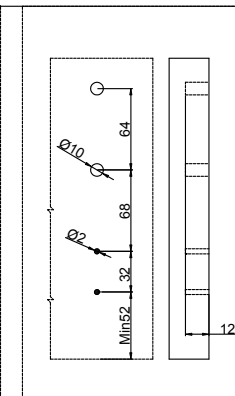
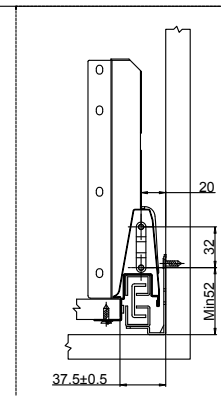
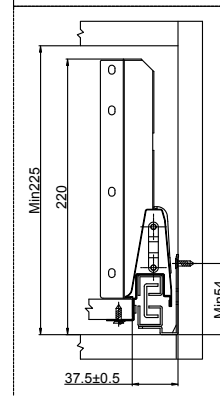

B86 Installation dimensions

Assembling dimensions of cabinet

Front fixing bracket

Drilling hole size on drawer front

Drawer back

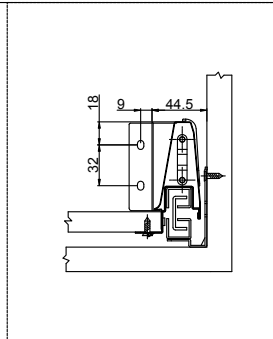
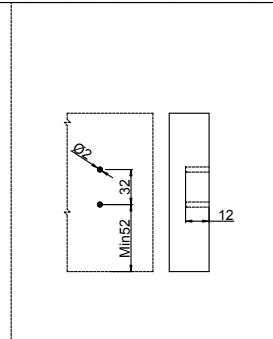
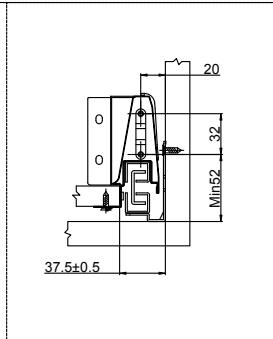
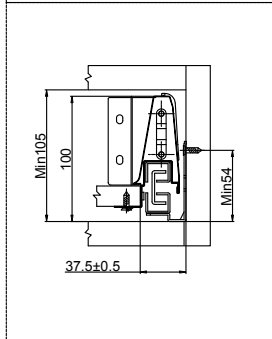

B120 Installation dimensions

Assembling dimensions of cabinet

Front fixing bracket

Drilling hole size on drawer front

Drawer back

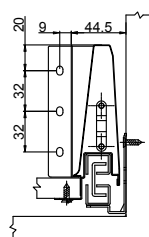
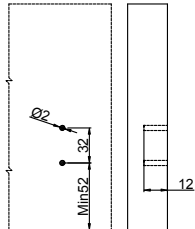
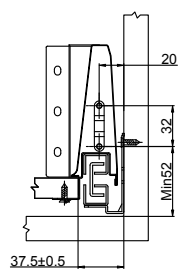
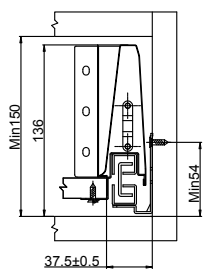

Install assembly

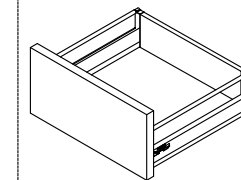
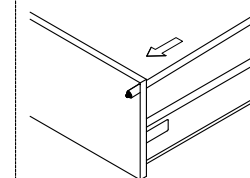
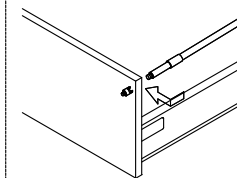
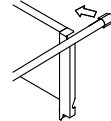
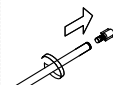

Bottom and back panels measurement

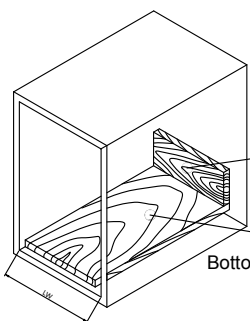

16mm Thickness panel
LW: Internal cabinet width

1 Back panel height (Refer to *)
Back panel length=LW-89±0.5

2 Bottom panel width=LW-75±0.5
Bottom panel length=Nominal length-7mm

3 Long tube=LW-71±0.5

4 Aluminium front length=LW-87±0.5

	B-86	B-120	B-140	B-164	B-204
	70	104	124	148	188

Slide installation

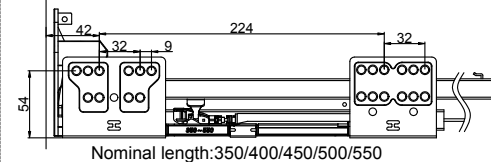
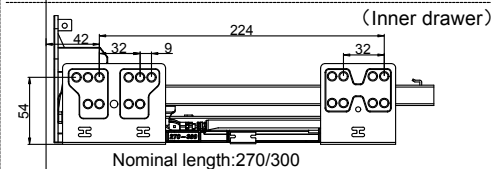
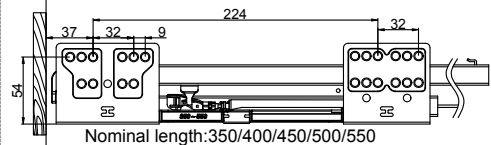
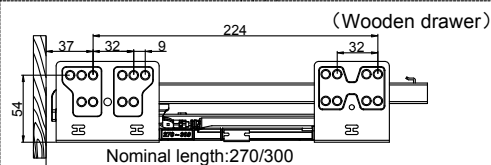

Installation & Disassembling manual

Install wooden drawer front

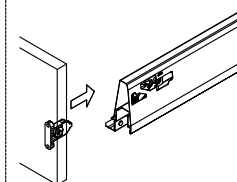
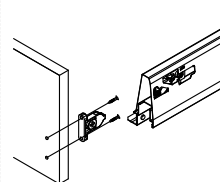

Disassemble wooden drawer front

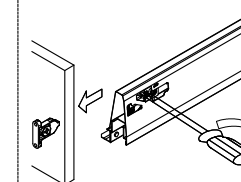
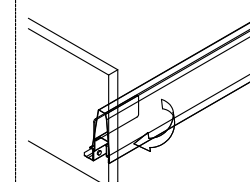

Drawer front adjustment

Wooden drawer front height adjustment: ±2mm

Drawer front right adjustment 1mm

Drawer front left adjustment 1mm

Gradient adjustment

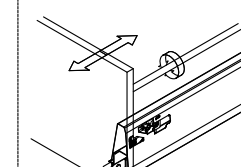
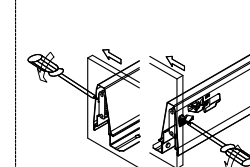
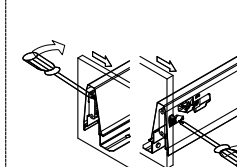
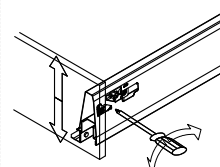

Drawer assembly

Install back panel

Install bottom panel

Install drawer front

Install screw for bottom panel

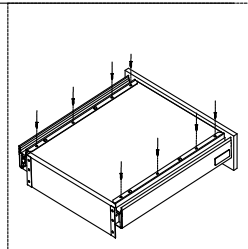
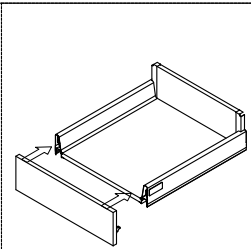
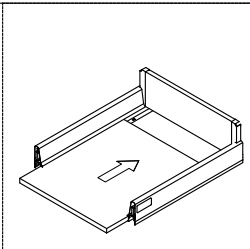
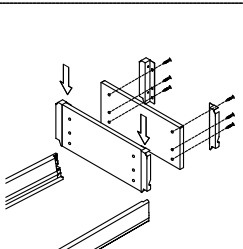

Install & Dismantle of drawer

1. Sliding out the slides

2. Method I: put the drawer from the top onto the slide

3. Method II: put the drawer from the front onto the slide

4. Lift the drawer up for dismantle

