

Living Top 15/30 kg

Slides for suspended panels
Sistemi di scorrimento per ante sospese



www.ternoscorrevoli.com/living-top



Living Top 15 kg

Slides for suspended panels
Sistemi di scorrimento per ante sospese

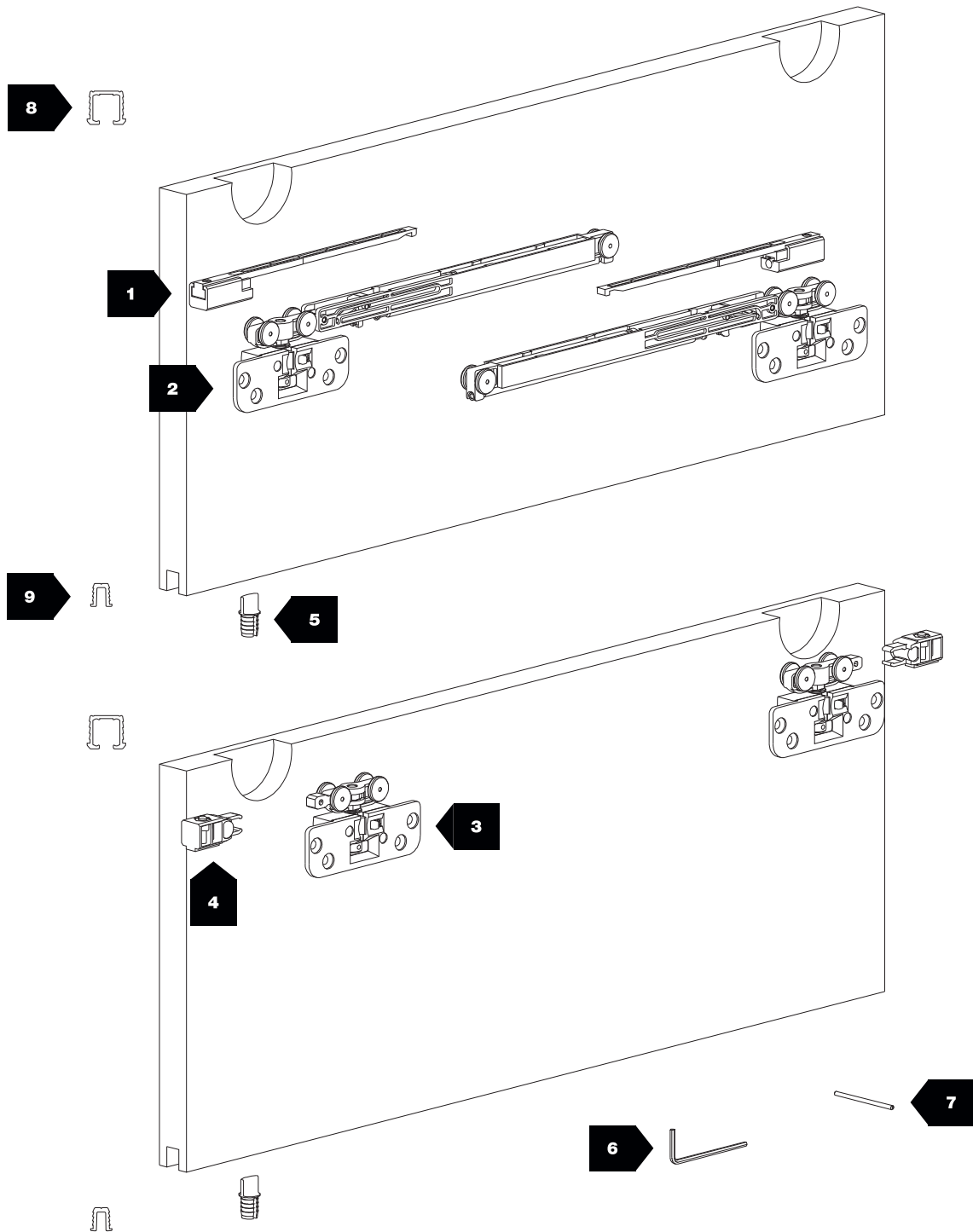

Min. 400 mm



15 kg



Living Top 15 kg

Slides for suspended panels
Sistemi di scorrimento per ante sospese

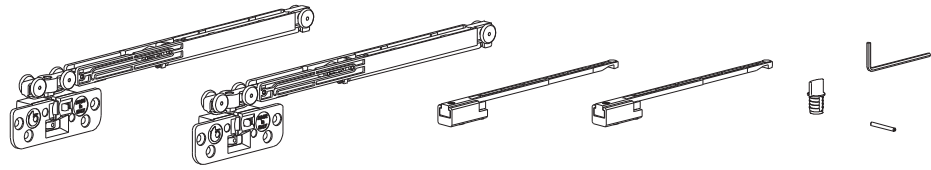
-  Kit for N.1 door
Kit per N.1 anta
-  N.2 Soft damper stoppers
N.2 Fermi ammortizzati



OLD CODE	NEW CODE		
2174/A/2	K.1251.2	15 kg	10x

-  Kit for N.1 door
Kit per N.1 anta
-  N.1 Soft damper stoppers
N.1 Fermi ammortizzati
-  N.1 Standard stoppers
N.1 Fermi standard

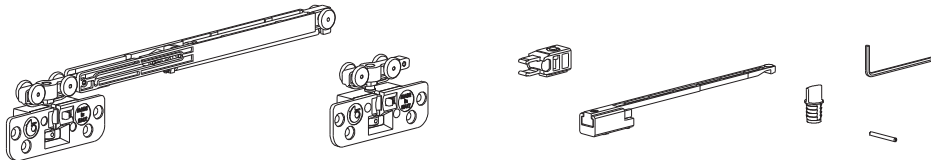

OLD CODE	NEW CODE		
2174/A/1	K.1251.3	15 kg	10x

-  Kit for N.1 door
Kit per N.1 anta
-  N.2 Standard stoppers
N.2 Fermi standard

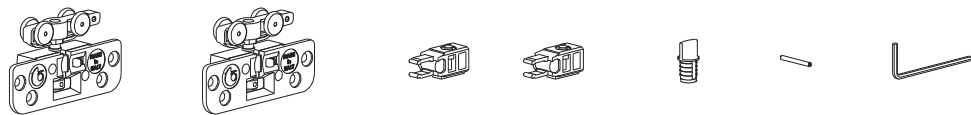

OLD CODE	NEW CODE		
2173/A	K.1251.1	15 kg	10x

MEASUREMENTS DESCRIPTION / DESCRIZIONE MISURE

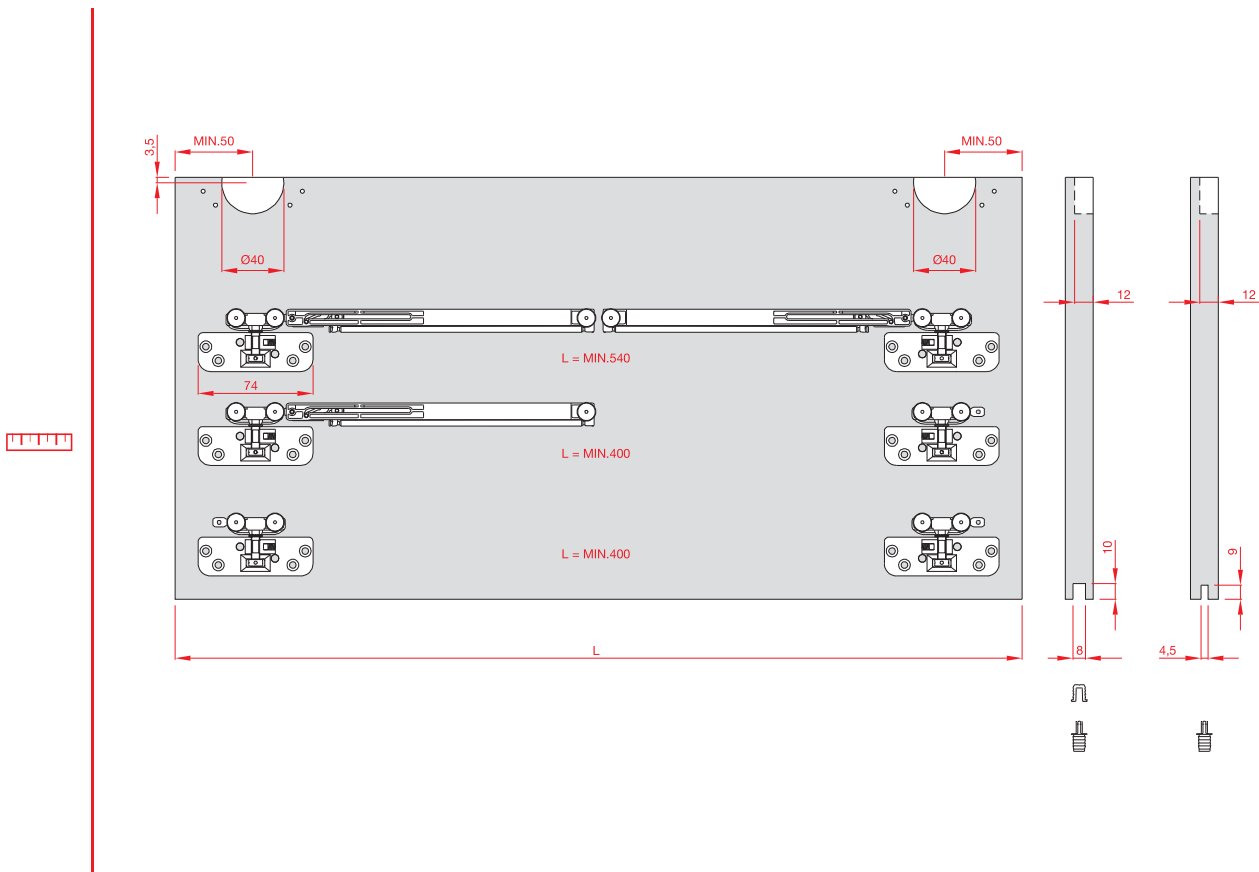

MEASUREMENTS DESCRIPTION / DESCRIZIONE MISURE

SP.18 → Z=9 X=24 W=4 Y=7
 SP.20 → Z=10 X=26 W=6 Y=9
 SP.22 → Z=11 X=28 W=8 Y=11

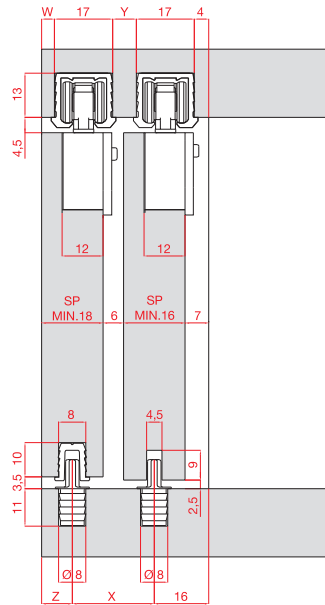

N.2 DOORS WITH SINGLE TRACK ART. 2175 / N.2 ANTE CON BINARIO SINGOLO ART. 2175



SP.16 → X=8 Y=10 Z=7
 SP.18 → X=6 Y=9 Z=6
 SP.20 → X=4 Y=8 Z=5
 SP.22 → X=2 Y=7 Z=4

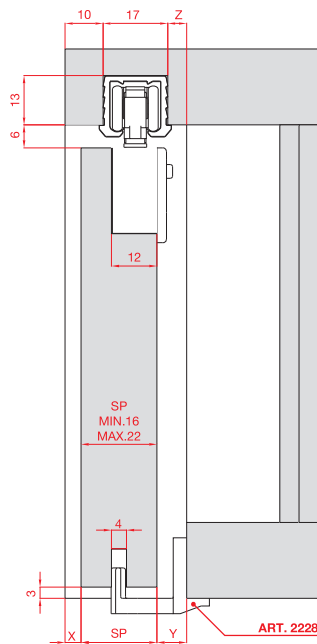

SP.16 → X=8 W=11 Y=9 Z=6
 SP.18 → X=6 W=9 Y=8 Z=5
 SP.20 → X=4 W=7 Y=7 Z=4
 SP.22 → X=2 W=5 Y=6 Z=3

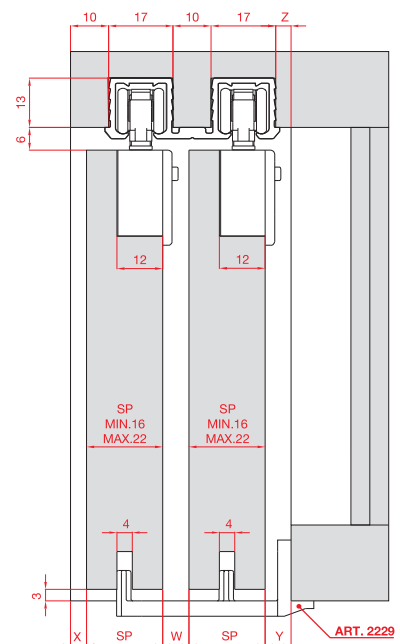

OPTIONAL

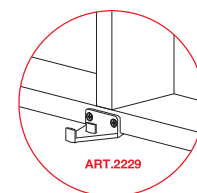
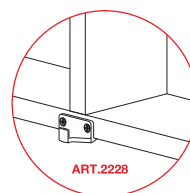
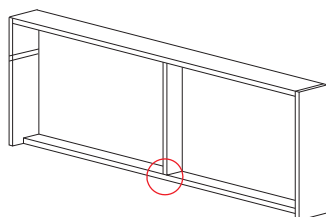

N.2 DOORS WITH DOUBLE TRACK ART. 2172 / N.2 ANTE CON BINARIO DOPPIO ART. 2172